



Software for
Business Intelligence

BizInt Smart Charts

Smart Chat: Latest BizInt Smart Charts Features

23 October 2024

Rebranding Reference Rows

- Now the **BizInt Smart Data Integrator** starting with the next release
- “Reference Rows” are now called “Integrated Rows”

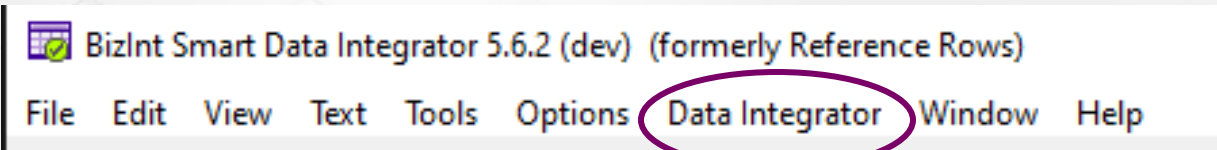

Changes in the Smart Data Integrator

- Chart Templates now supported in the Smart Data Integrator
- Fixing a number of bugs related to charts with hidden source rows
 - Row and cell shading
 - Crashes when applying rules
 - Handling hidden rows

Smart Data Integrator - Cell Attribution

- Show Cell Sources... on the Data Integrator menu controls how the source of a cell is shown
- Attributions are in grey (not color)



Show Cell Source Options

Specify how the database source of a cell is shown in exports:

At the bottom of the cell

Following the cell text

Do not show cell source

OK Cancel Help...

Allergen
Immunomodulator

14a COR

Allergen
Immunomodulator
{14a COR}

Allergen
Immunomodulator

Changes to Combine / Update coming soon

- Simpler workflow
 - only a single panel
- In many cases, only one click needed to combine
- Automatic handling for sequence alignments

Combine Charts

Chart Type: Patents

Available Charts

- Title Number One
...source notes.
- Title Number Two
...source notes.
- Title Number Three
...source notes.

Charts to Combine

- Title Number Four
...source notes.
- Title Number Five
...source notes.

Title: Brand new title

Advanced

Group rows by common family
 Do not change row status
 Close chart after combining

OK Cancel

New Chart Creation Workflow

- No longer ask for a chart template during chart creation.
- A default "Editor's Choice" chart template is applied to all new charts during import.
- New features for applying and managing chart templates.

NEW Manage Templates command

- File menu or via Apply Template
- Rename a template*
- Delete a template*
- * user templates only
- Make a template the default template for that chart type

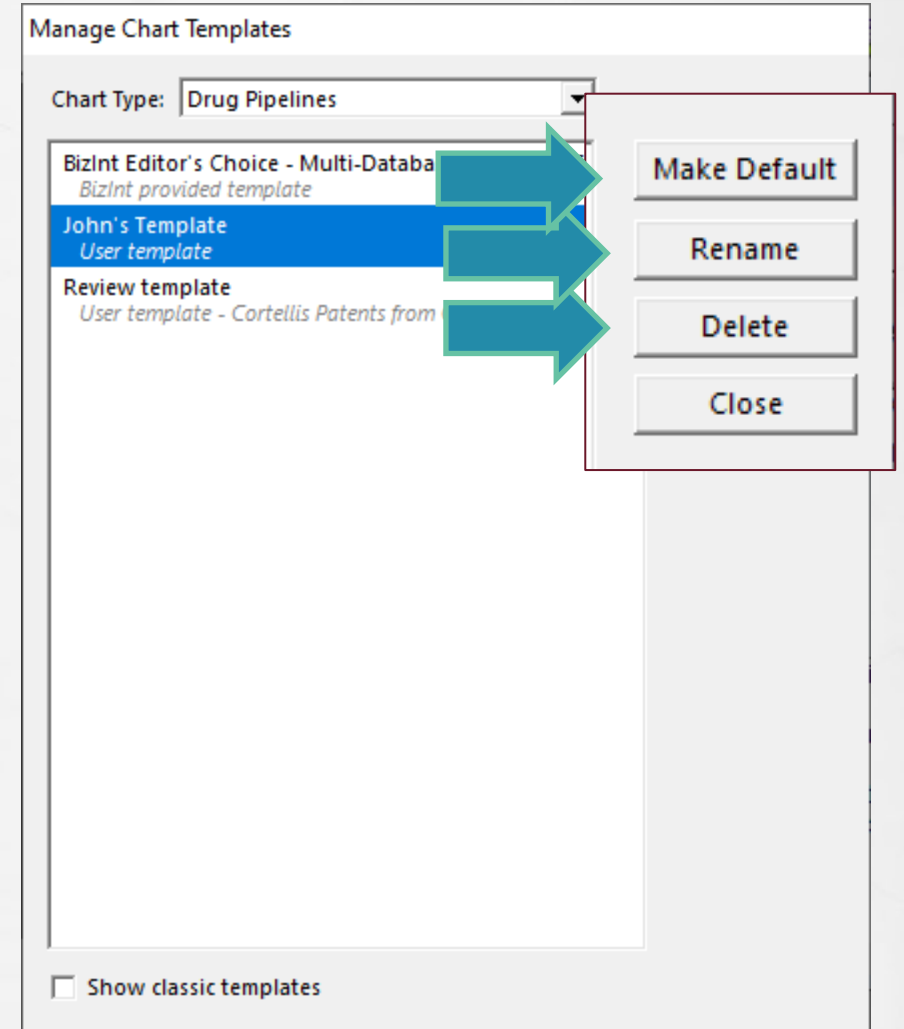

Use compatible templates

- You can apply any template for the same chart type to a chart
- Example: apply a chart template created from Orbit to a chart from CAplus
- Example: apply template from ClinicalTrials.gov to a chart from TrialTrove

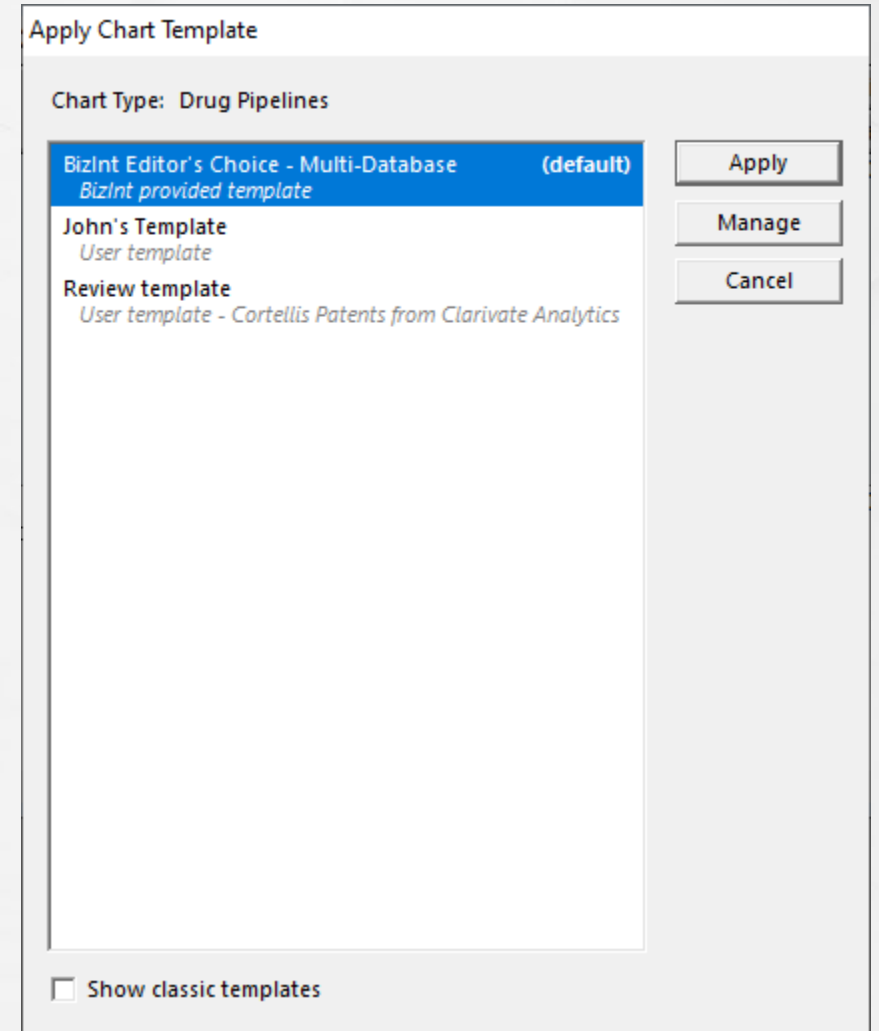

Custom Styles

- Our latest export changes included new styles
- Adding custom styles is easy - just ask us
- For example... a customer wanted some borders in the patent family subtable in word

Combined: Merkel Cell Carcinoma - Pharmaprojects, Cortellis, R&D Insight

	Product	Database	Originator	Drug Development Phase			Mechanism of Action
				Disease	Status	Country	
1 Link	ALT 803	Adis R&D Insight	Altor BioScience Corporation (Originator) NantKwest (Originator)	Bladder cancer	Phase II/III	USA	Interleukin-15 receptor agonists
				Merkel cell carcinoma	Phase II	USA	
				Acute myeloid leukaemia	Phase II	USA	
				Multiple myeloma	Phase I/II	USA	
				Non-small cell lung cancer	Phase I/II	USA	
				Haematological malignancies	Phase I/II	USA	
				Non-Hodgkin's lymphoma	Phase I/II	USA	
				Pancreatic cancer	Phase I/II	USA	
				Malignant melanoma	Phase I	USA	
				HIV infections	Phase I	USA	
				Bacterial infections	Preclinical	USA	
2 Link	ATN-161	Citeline Pharmaprojects	Attenuon	Cancer, brain	No Development Reported	Alpha5beta1 integrin antagonist Alphavbeta3 integrin antagonist Alphavbeta5 integrin antagonist Angiogenesis inhibitor Integrin antagonist	
				Cancer, head and neck	No Development Reported		
				Cancer, renal	No Development Reported		
				Cancer, breast	No Development Reported		
				Cancer, carcinoid	No Development Reported		
				Cancer, oesophageal	No Development Reported		
				Cancer, sarcoma, lipo	No Development Reported		
				Cancer, Merkel cell carcinoma	No Development Reported		
				Cancer, lung, non-	No Development		

Combined: Merkel Cell Carcinoma - Pharmaprojects, Cortellis, R&D Insight

	Product	Database	Originator	Drug Development Phase			Mechanism of Action
				Disease	Status	Country	
1 Link	ALT 803	Adis R&D Insight	Altor BioScience Corporation (Originator) NantKwest (Originator)	Bladder cancer	Phase II/III	USA	Interleukin-15 receptor agonists
				Merkel cell carcinoma	Phase II	USA	
				Acute myeloid leukaemia	Phase II	USA	
				Multiple myeloma	Phase I/II	USA	
				Non-small cell lung cancer	Phase I/II	USA	
				Haematological malignancies	Phase I/II	USA	
				Non-Hodgkin's lymphoma	Phase I/II	USA	
				Pancreatic cancer	Phase I/II	USA	
				Malignant melanoma	Phase I	USA	
				HIV infections	Phase I	USA	
				Bacterial infections	Preclinical	USA	
2 Link	ATN-161	Citeline Pharmaprojects	Attenuon	Cancer, brain	No Development Reported		Alpha5beta1 integrin antagonist Alpha5beta3 integrin antagonist Alpha5beta5 integrin antagonist Angiogenesis inhibitor Integrin antagonist
				Cancer, head and neck	No Development Reported		
				Cancer, renal	No Development Reported		
				Cancer, breast	No Development Reported		
				Cancer, carcinoid	No Development Reported		
				Cancer, oesophageal	No Development Reported		
				Cancer, sarcoma, lipo	No Development Reported		
				Cancer, Merkel cell carcinoma	No Development Reported		
				Cancer, lung, non-small cell	No Development Reported		
				Cancer, sarcoma, osteo	No Development Reported		

Database Changes (Patents)

- PatBase - Independent Claims available in a column; display of Folder notes improved
- Support for MARPAT assembled structures including an index of assembled structures
- Support for Patsnap Analytics
- Support for Patsnap BIO coming this winter
- Support for GQ Discovery Browser annotations coming soon

Database Changes (Drug Development Suite)

- Citeline - added Drug Type to Pharmaprojects; coming soon to TrialTrove
- AdisInsight - new biomarkers, targets, and more coming soon
- Beacon Intelligence - initial support now available
- Patsnap Synapse - coming soon

Bullseye Chart – Merkel Cell Carcinoma

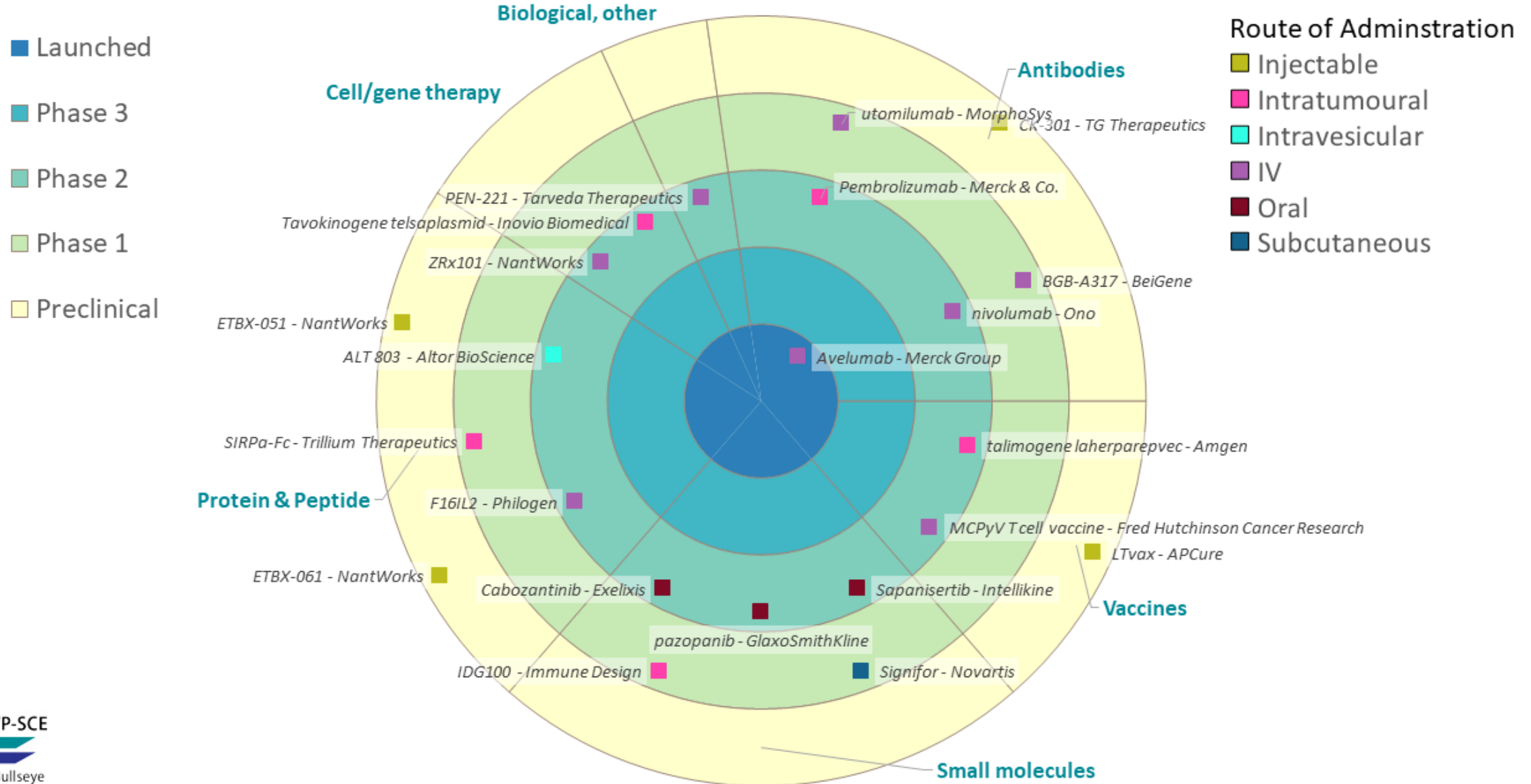

Piano Chart – Merkel Cell Carcinoma Pipeline

Preclinical	Phase I	Phase II	Launched
CK-301 TG Therapeutics	BGB-A317 BeiGene	nivolumab Ono	Avelumab Merck Group
ETBX-051 NantWorks	utumilumab MorphoSys	Pembrolizumab Merck & Co.	
ETBX-061 NantWorks	SIRPa-Fc Trillium Therapeutics	PEN-221 Tarveda Therapeutics	
LTvax APCure	IDG100 Immune Design	Tavokinogene telsaplasmid Inovio Biomedical	
	Signifor Novartis	ZRx101 NantWorks	
		ALT 803 Altor BioScience	
		F16IL2 Philogen	
		Cabozantinib Exelixis	
		pazopanib GlaxoSmithKline	
		Sapanisertib Intellikine	
		MCPyV T cell vaccine Fred Hutchinson Cancer Research	
		talimogene laherparepvec Amgen	

Product Category

- Antibodies
- Biological, other
- Cell/gene therapy
- Protein & Peptide
- Small molecules
- Vaccines



Software for
Business Intelligence

BizInt Smart Charts

BIZINT

THE JOURNEY CONTINUES...

Questions?
Requests?

support@bizint.com